

★特性/Features

Various high power inductors are superior to be high saturation for surface mounting

↑ 各种高功率电感优越高饱和和表面安装

Inductance tolerance:1000uH~3000uH±10%

电感公差:1000uH~3000uH±10%,

Inductance drop=10%typ.at rated IDC/电感落差: 10%typ.at rated IDC

Operating temperature range:-25°C~+85°C/温度工作范围-25°C~+85°C

SR7870LF TYPE

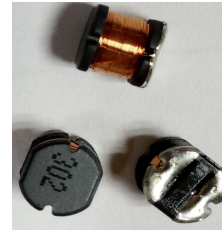

★机械尺寸/Dimensions(UNIT:mm)

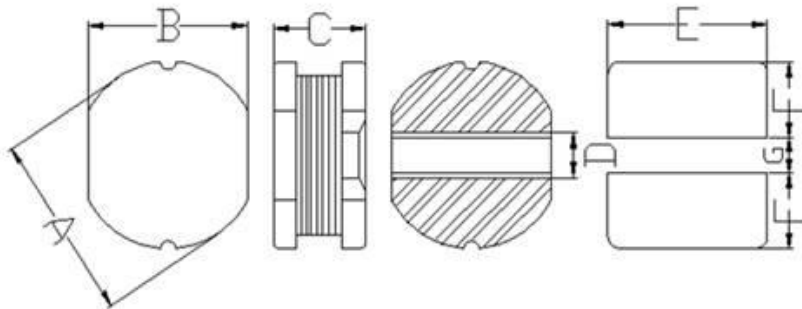

A	7.8±0.3
B	7.0±0.3
C	7.0±0.3
D	2.4Ref
E	7.5Ref
F	3.0 Ref
G	2.4 Ref

★标准的电气说明书/Standard electrical specifications

Part number 规格型号	Inductance (uH) 电感量	Test Frequency (KHz) 测试频率	DC Resistance 最大直流电阻 (Ω) (max)	I. D. C 额定电流 (A) (max)
SR7870LF-102K	1000	1	3.90	0.50
SR7870LF-152K	1500	1	5.60	0.42
SR7870LF-202K	2000	1	7.40	0.39
SR7870LF-252K	2500	1	9.50	0.35
SR7870LF-302K	3000	1	10.70	0.30

★超出以上规格的特殊要求可依客户要求设计

Special inquiries besides the above common used types can be met on your requirement.